

- 96'x 93'x 23' grid
- 8,000 square feet total
- 1800 amps (additional power available)
- Make-up/dressing room (air conditioned)
- Production offices (air conditioned)
- Electronic phone system
- Drive-in truck door 14' high x 10' wide
- 24 reserved parking spaces

stage 3

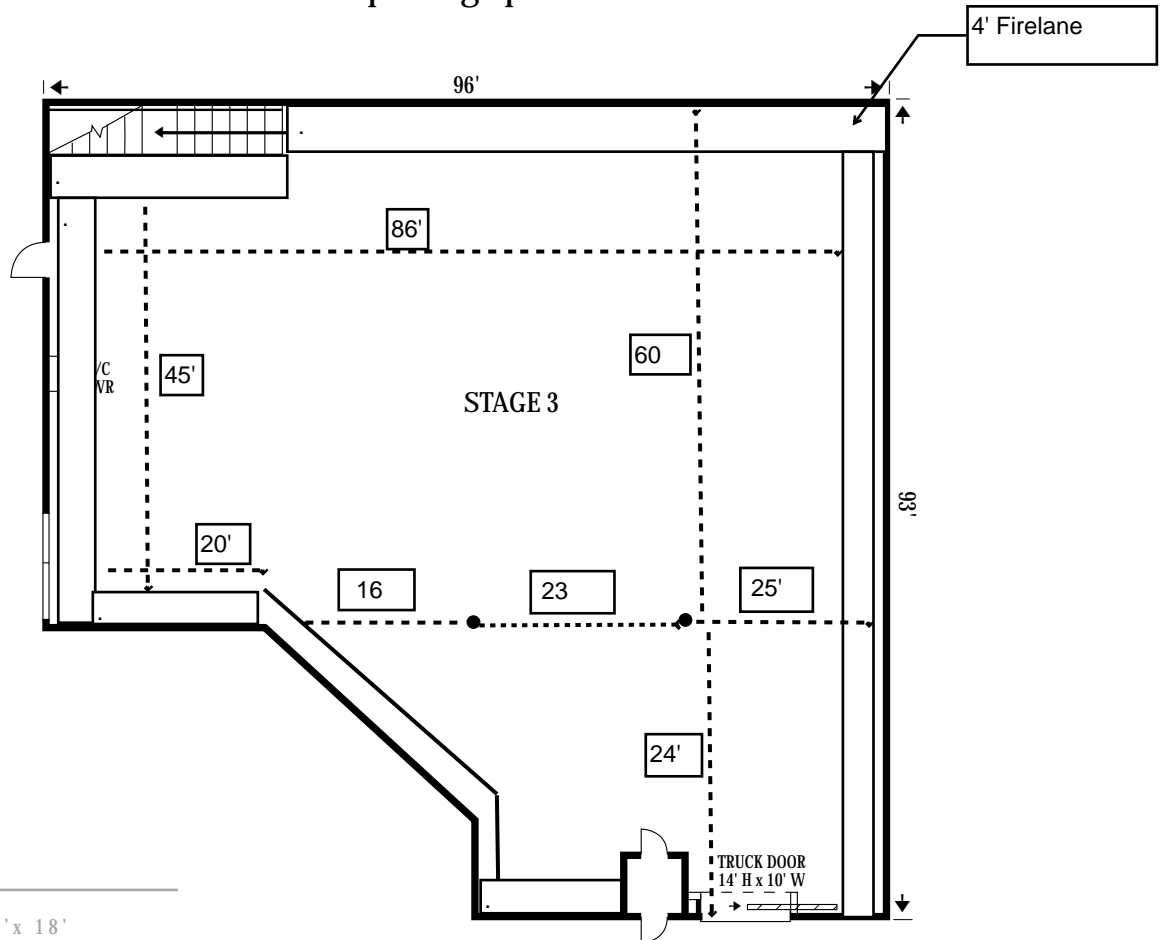

Note: Not to scale - approximate measurements to be verified by client.

- stage 1 100'x 100'x 18'
- stage 2 50'x 80'x 17'
- stage 3 96'x 93'x 23'
- stage 4 70'x 70'x 24'
- stage 6 112'x 88'x 24'
- stage 7 116'x 96'x 22/25'

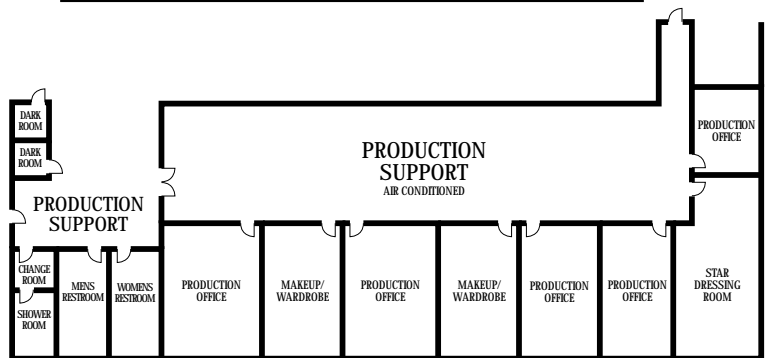

- 70' x 70' x 24' grid
- 4,900 square feet total
- Two wall Cyclorama 44' x 37' x 24'
- 24' x 100' black curtain (optional)
- 1200 amps of stage power (additional power available)
- Make-up/dressing room (air conditioned)
- Production offices (air conditioned)
- Electronic phone system
- Loading dock with drive-in ramp
12' high x 18' wide
- 22 reserved parking spaces

stage 1	100' x 100' x 18'
stage 2	50' x 80' x 17'
stage 3	96' x 93' x 23'
stage 4	70' x 70' x 24'
stage 6	112' x 88' x 24'
stage 7	116' x 96' x 22/25'

Stage 4

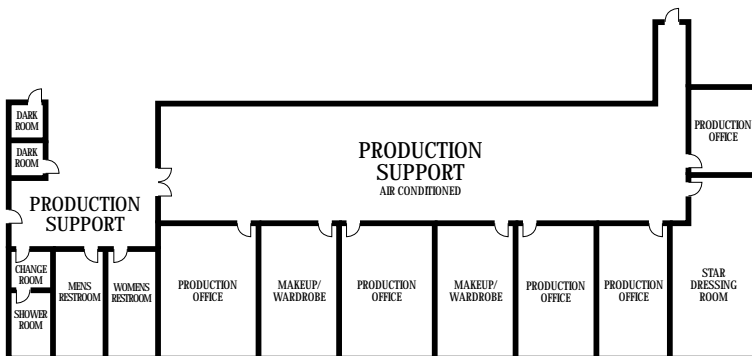
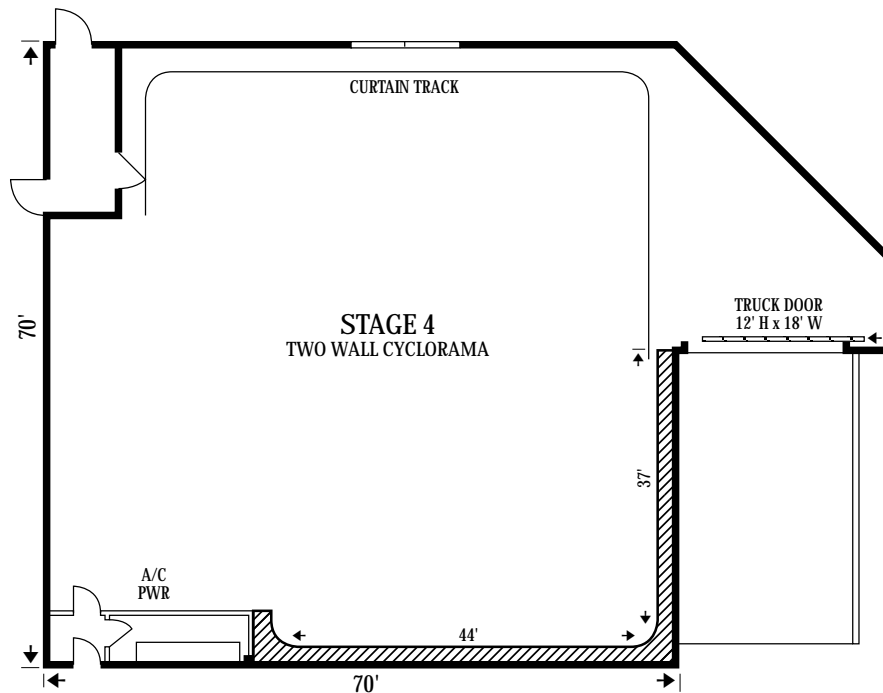

• 6,000 square feet of air conditioned production space on second floor

PERFECT FOR A TV SERIES

stage 6

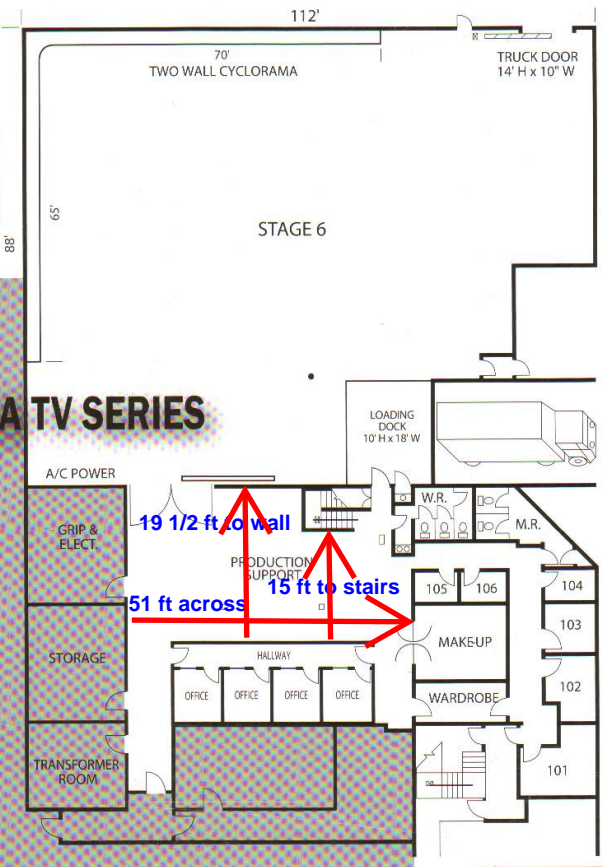

DIGITAL

- stage 1 100' x 100' x 18'-25'
- stage 2 50' x 80' x 16-18'
- stage 3 96' x 93' x 23'
- stage 4 70' x 70' x 24'
- stage 5 30' x 30' x 16' **NEW**
- stage 6 112' x 88' x 24'**
- stage 7 116' x 96' x 22-25'

- 112'x 88'x 24' grid
- 16,200 square feet total
- 9,800 square feet of stage space
- Two wall Cyclorama (65' x 70' x 24')
- 3,400 square feet (14' high) production support
- 3600 amps of stage power
- Separate make-up & dressing room
- Production offices with Digital phone system
- Loading dock 10' high x 18' wide
- Drive-in truck door 14' high x 10' wide
- 41 reserved parking spaces

116'

STAGE 7

10' X 14' Roll Up Door

10' X 14' Roll Up Door

96'

Stairs To Second Floor

Main Power

Storage

GMT
Lighting
&
Grip

WOMEN

Stairs To Second Floor

TRASH

DECK

10' X 14' ROLL UP DOOR

* not to scale

